

Clipsal 56PA320

VIEW A

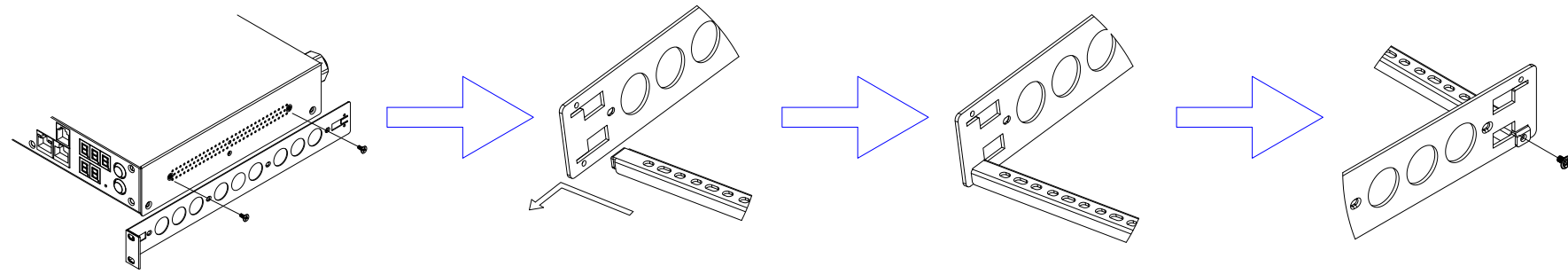

VIEW B

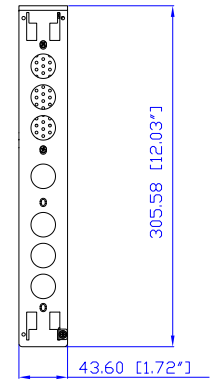

Rear



Clipsal 56PA320

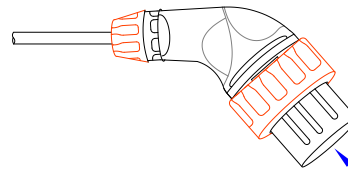

See VIEW A

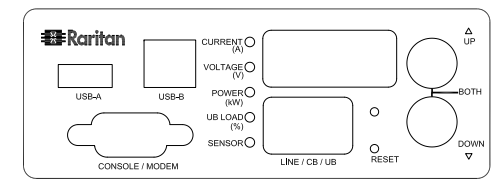

VIEW C

TOP

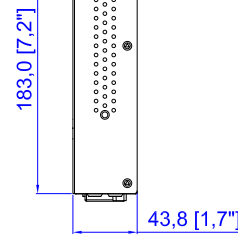
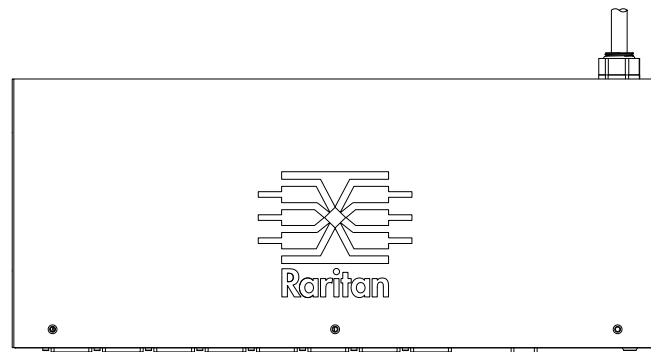

Front

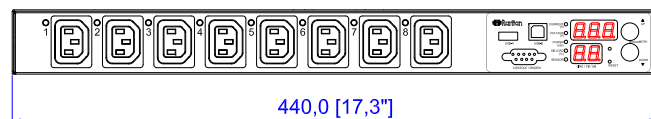

440,0 [17,3"]

See VIEW C

See VIEW B

NOTES:
ALL DIMENSIONS ARE MILLIMETERS[INCHES].



PROJECTION
THIRD ANGLE

DO NOT SCALE DRAWING

SHEET 1 OF 1

THIS DRAWING AND SPECIFICATIONS HEREIN ARE THE PROPERTY OF RARITAN, INC. AND SHALL NOT BE COPIED, REPRODUCED OR USED, IN WHOLE OR IN PART, AS THE BASIS FOR THE MANUFACTURE OR SALE OF ITEMS WITHOUT WRITTEN PERMISSION FROM RARITAN, INC. THIS DRAWING IS BASED UPON LATEST AVAILABLE INFORMATION AND IS SUBJECT TO CHANGE WITHOUT NOTICE.

DRAWN :	Eva LIN	June 14, 2011
ENGINEER:	Sam_L	June 15, 2011
APPROVED:	Kevin_C	June 16, 2011

TITLE: iPDU One U,
Single Phase, 20A/240V
Input: Clipsal 56PA320 ,
Output (8)IEC320 C13

DWG NO. **MPX2-2190A2R** REV. **A**