

IEC60309 32A

VIEW A

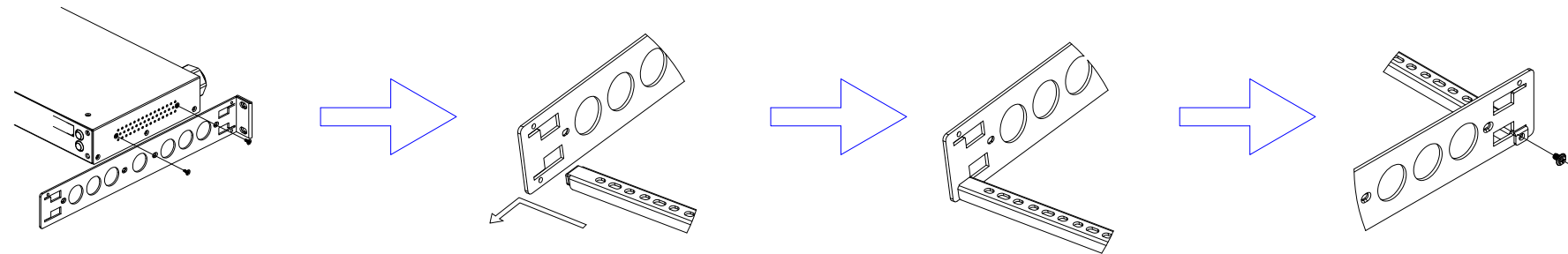

VIEW B

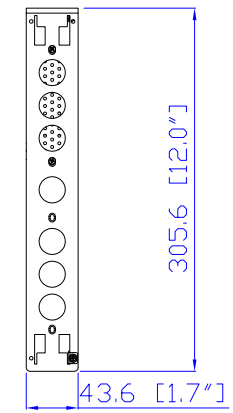

Rear

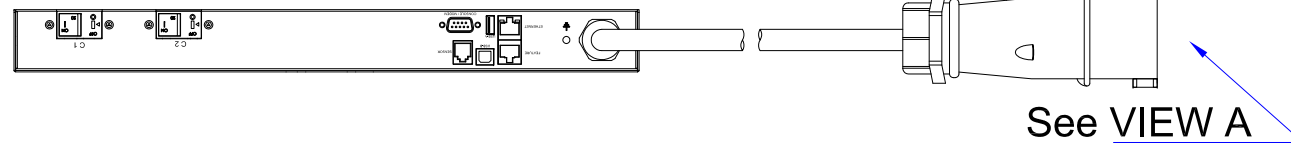

IEC60309 32A

See VIEW A

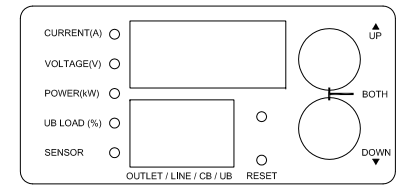

VIEW C

TOP

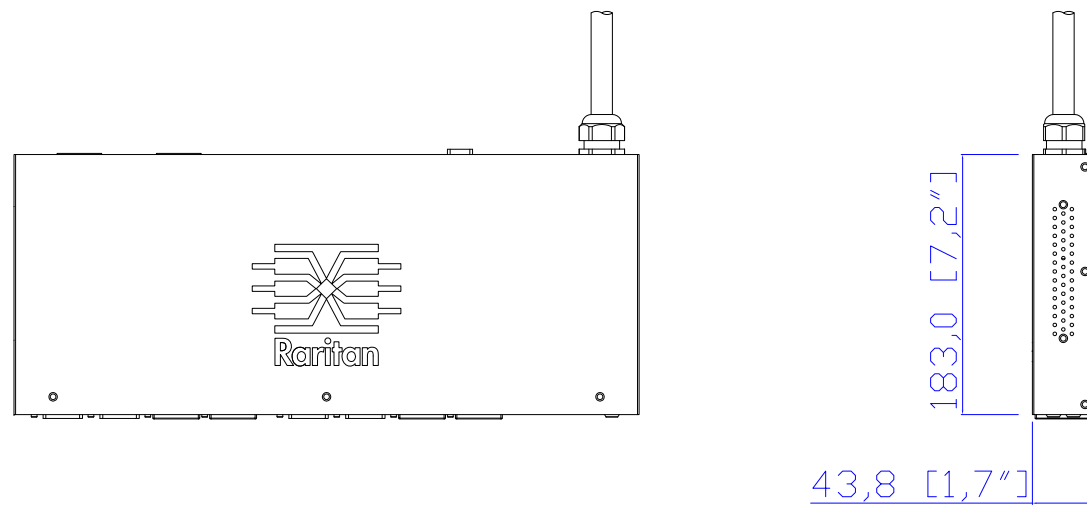

Front

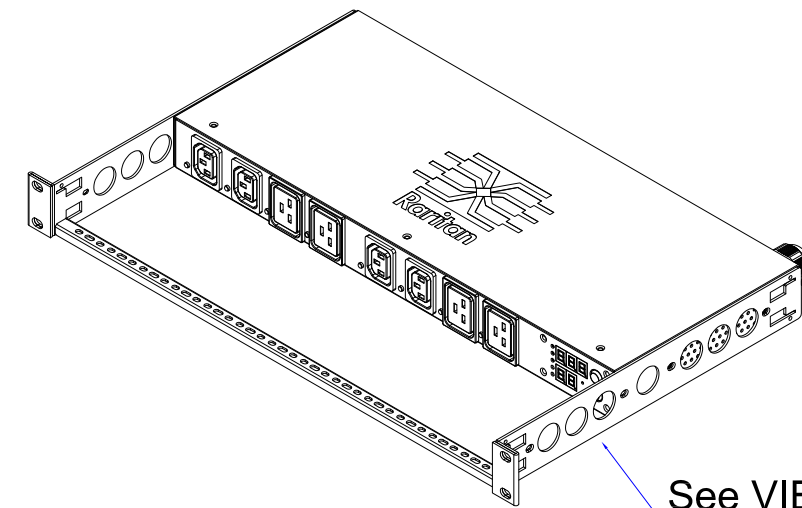
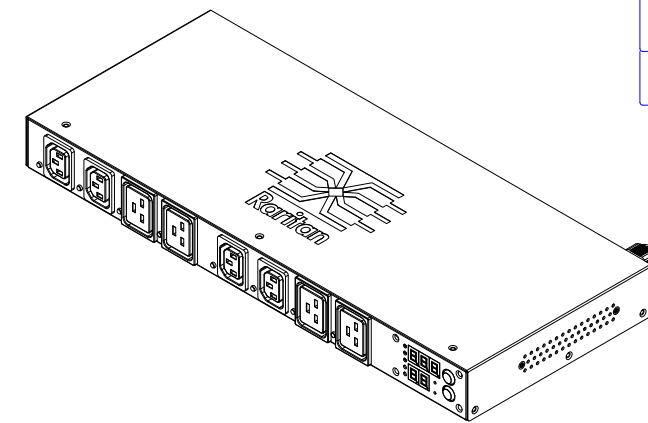
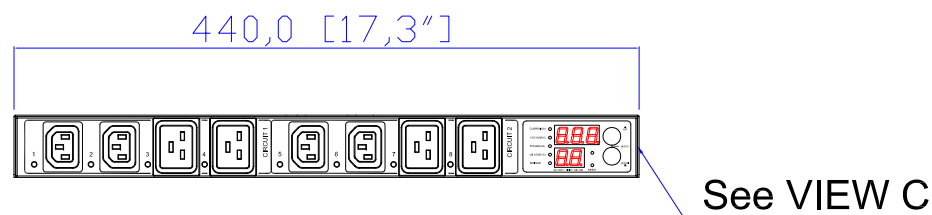

See VIEW B

NOTES:

1.ALL DIMENSIONS ARE MILLIMETERS[INCHES].

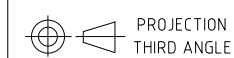

PROJECTION
THIRD ANGLE

DO NOT SCALE DRAWING

SHEET 1 OF 1

THIS DRAWING AND SPECIFICATIONS HEREIN ARE THE PROPERTY OF RARITAN, INC. AND SHALL NOT BE COPIED, REPRODUCED OR USED, IN WHOLE OR IN PART, AS THE BASIS FOR THE MANUFACTURE OR SALE OF ITEMS WITHOUT WRITTEN PERMISSION FROM RARITAN, INC. THIS DRAWING IS BASED UPON LATEST AVAILABLE INFORMATION AND IS SUBJECT TO CHANGE WITHOUT NOTICE.

TITLE:

iPDU Zero U,
Single phase 32A / 200V-240V
Plug Type: IEC309 32A
Output Type: (4)IEC320 C13 ,(4)IEC320 C19

DWG NO.

MPX2-5170R & MPX2-4170R

REV.

A

DRAWN :	EVA LIN	Apr.30, 2014
ENGINEER:	Siang_H	Apr.30, 2014
APPROVED:	Tom_H	Apr.30, 2014